

45-LB x2 CAPACITY COIN STACK DRYER

AD-444



ADC™ built its reputation over the last 50 years on the AD Series dryer. With a passion for innovation and design, top-to-bottom quality, and the ability to customize your build, the AD Series dryers are a popular choice for vended laundry locations. In choosing an AD Series Dryer, you choose a user-friendly and reliable vended laundry system that helps you meet your customers' needs.

COMPUTER OPERATED

ADC™ brought computer-operated dryers to the market, and today we continue to be a leader in applying technology to dryer operation.

The AD Series features an accessible design with easy-to-read LCD screens and a user-friendly multilingual interface.

Our advanced technology allows for self-diagnostic controls, which constantly monitor and give you up-to-date details and information on your machine.

PAYMENT OPTIONS

The AD series offers an array of Customer Payment options.

1. The standard preconfigured mechanical coin drop.
2. Configurable Multi Coin Drop
3. The Card Reader Ready option

As times change, you can change your method for receiving payments as well.



STANDARD FEATURES

- 45-lb capacity per pocket
- 14.6 cu. ft. basket volume per pocket
- 106,000 BTU/hr heat input and 530 cfm per pocket
- Partial axial airflow
- Steel door with gasketless glass
- Two 8" diameter top exhaust connections
- Optional single 10" exhaust connection
- 1/2" gas connection per pocket
- Single coin drop
- Fits through a standard 36" door
- Available in gas heat
- Available in gray or white front and cabinet

See adclaundry.com for warranty details.

VISIT ADCLAUNDRY.COM FOR MORE INFORMATION.

45-LB x2 CAPACITY COIN STACK DRYER

AD-444



FRONT VIEW

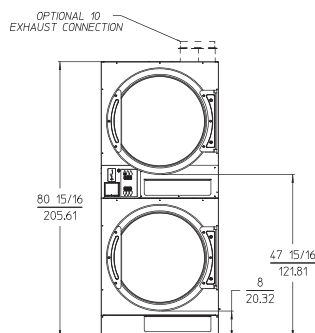

REAR VIEW

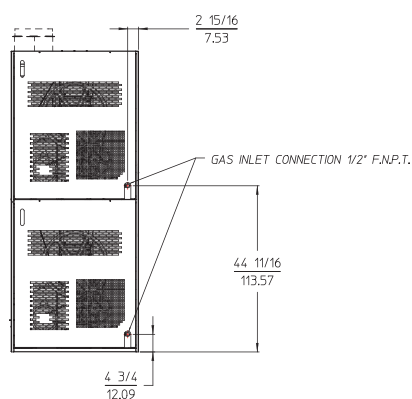

PLAN VIEW

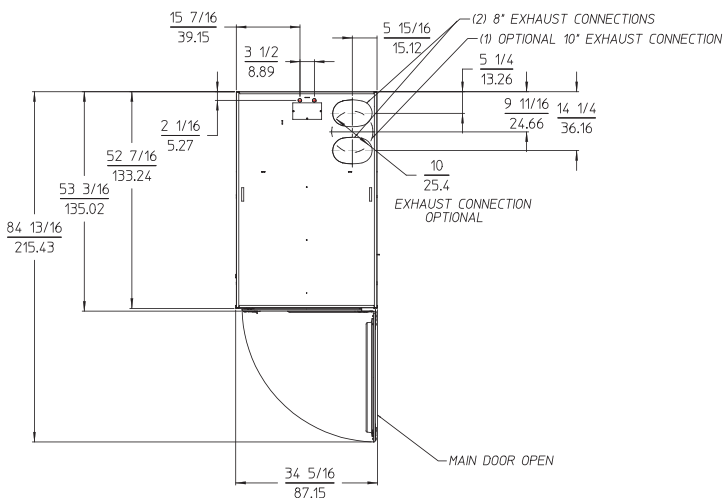

AD-444 COIN READY	GAS
CAPACITY	
Maximum Capacity Dry Weight (per pocket) — lbs (kg)	45 (20.41)
Tumbler Diameter — in. (cm)	32-3/4 (83.19)
Tumbler Depth — in. (mm)	30 (76.20)
Tumbler Volume (per pocket) — cu. ft. (L)	14.6 (413.43)
Tumbler/Drive Motor (per pocket) — hp (kW)	3/4 (0.56)
Blower/Fan Motor (per pocket) — hp (kW)	N/A
DIMENSIONS	
Cabinet Width — in. (cm)	34-5/16 (87.15)
Cabinet Depth — in. (cm)	53-3/16 (135.02)
Cabinet Height — in. (cm)	80-15/16 (205.6)
Door Opening (diameter) — in. (cm)	27 (68.58)
Door Sill Height — in. (cm)	Top pocket 50-1/4 (127.64) Bottom pocket 10-1/4 (26.04)
Water Connection	N/A
Dryers per 20' / 40' Container	8 / 16
Dryers per 48' / 53' Truck	25 / 27
APPROXIMATE WEIGHT	
Approximate Net Weight — lb (kg)	905 (410.5)
Approximate Shipping Weight — lb (kg)	940 (426.4)
Voltage Available	120-240V 1Ø 2w 50 / 60 Hz
Airflow 50 HZ — CFM (CMM)	442 (12.52)
Airflow 60 HZ — CFM (CMM)	530 (15)
Heat Input — BTU/hr (kcal/hr)	106,000 (26,712)
Gas Inlet Connection Size — in.	1/2 F.N.P.T.
Exhaust Connection (diameter) — in. (cm)	(2) 8 (20.32) Standard (1) 10 (25.4) Optional